

Installation Manuals

Printer Setup for Chinese Characters

EPSON TM-U220 Receipt (Simplified Chinese Driver)

1. DIP SWITCH, to set resident characters to Simplified Chinese GB18030.
Note: To check resident characters, hold the Feedback button of printer before powering on.

EPSON TM-T82 Receipt (South Asian Driver)

1. Memory Switch, to set resident characters to Simplified Chinese GB18030.
Note: To check resident characters, hold the Feedback button of printer before powering on.
 - To set resident characters to Simplified Chinese GB18030:
[简体中文 GB18030:]
 - a. Hold the Feedback button of printer before powering on.
[简体中文 GB18030:]
 - b. Hold again the feedback button for more than 1 second to display the menu option. [简体中文 GB18030:]

Installation Manuals

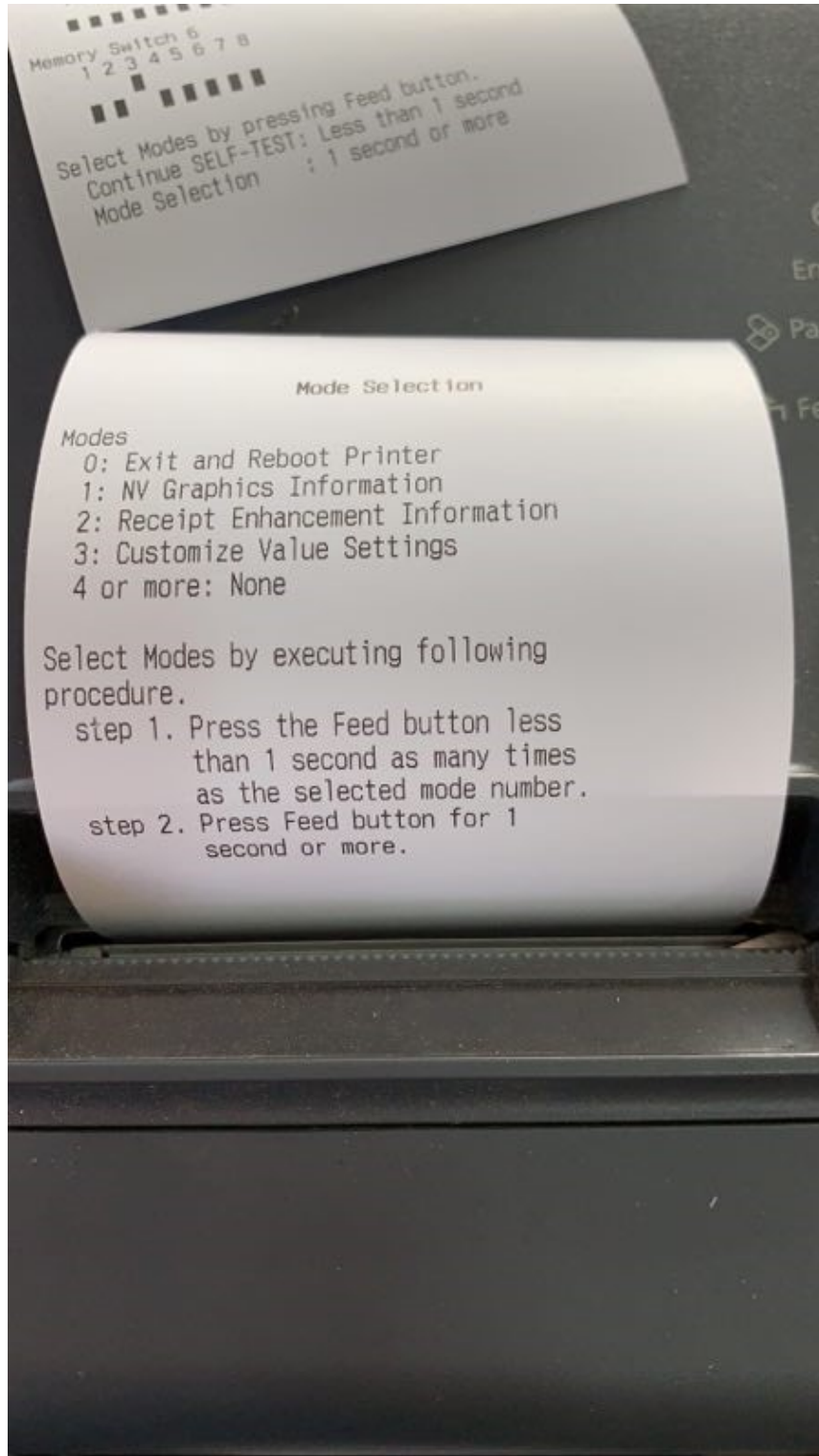

- d. Select '3: Multi Language Font'. (Click the feedback button 4 times and hold it on 4th time) [3: Multi Language Font'(4"4"44444444)]

Installation Manuals

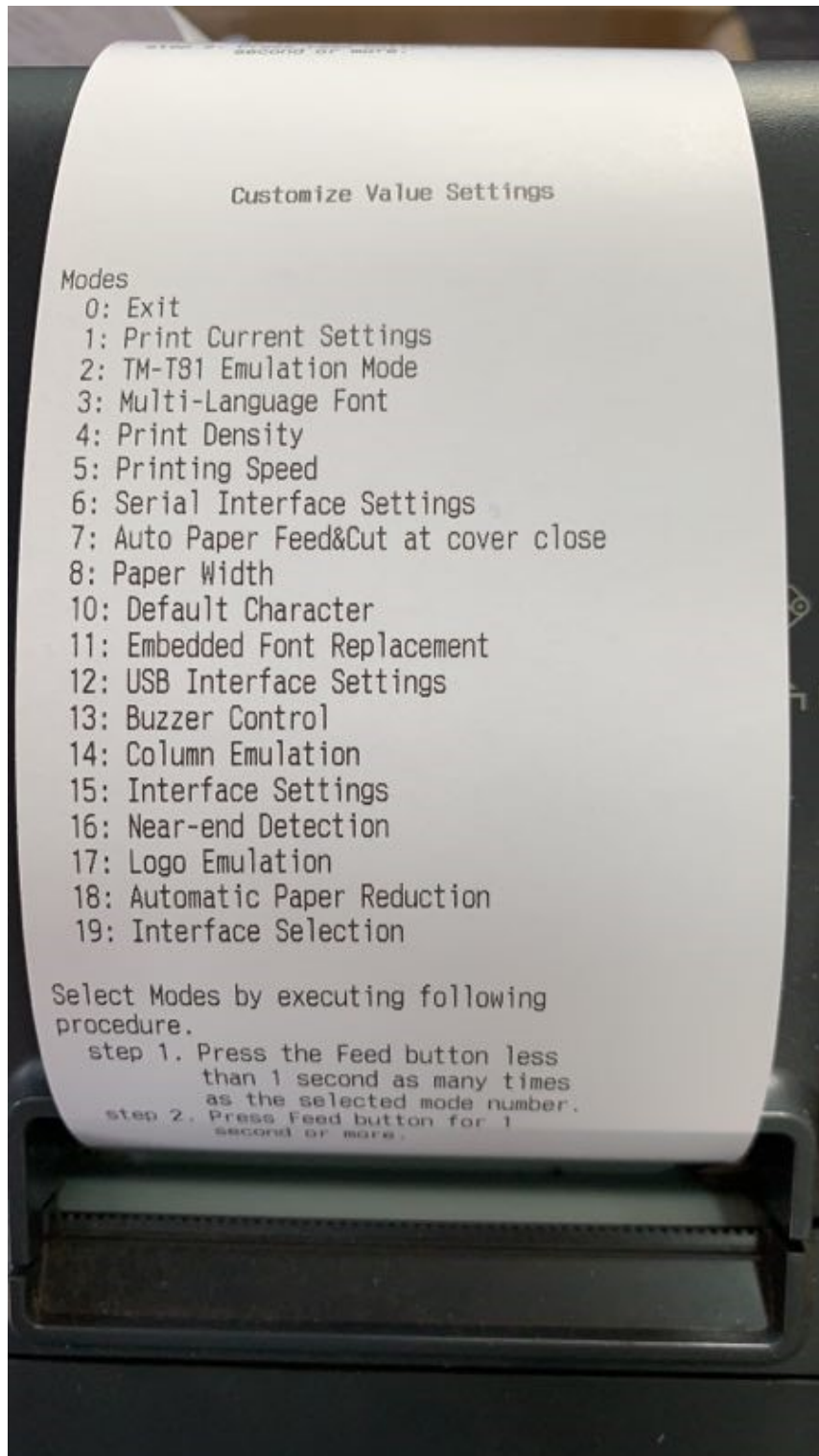

- e. If * is on '1: Thai, Vietnam', select '2: Simplified Chinese'.
(Click the feedback button 3 times and hold it on 3rd time)
[* '1: Thai, Vietnam' '2: Simplified Chinese'
(" " 3 " " " 3)]

Installation Manuals

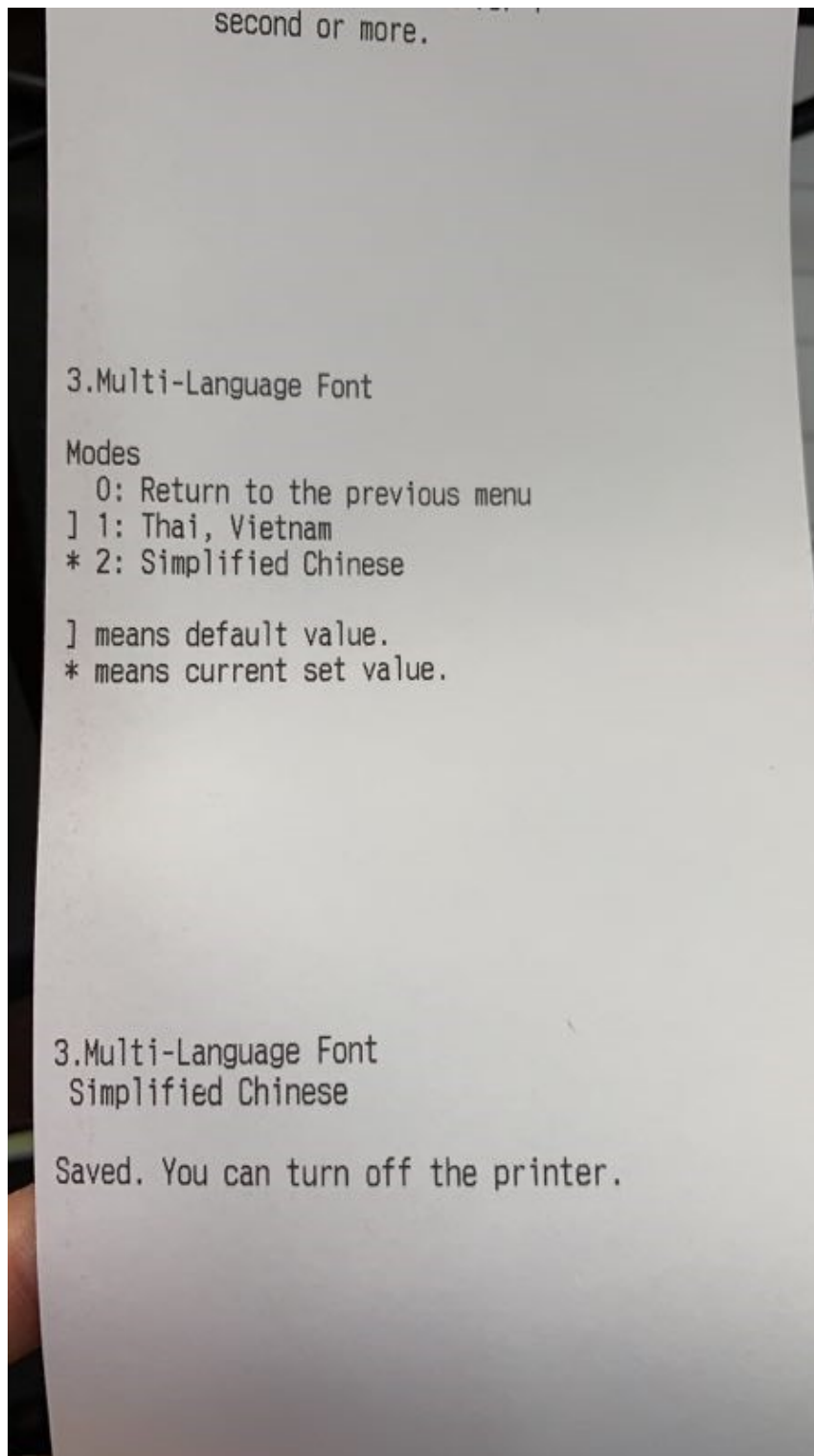

- f. Proceed to exit afterwards. []]
2. On POS Config (Setting.xml in Resto), in Printer Settings, set Print Receipt Actual to 48 and Print Receipt Limit to 48. [] POS Config[]setting.xml[]Printer Settings[]Print Receipt Actual=48 [] Print Receipt Limit=48.]
3. On POS Config (Setting.xml in Resto), in Printer Settings, set Print Receipt DisableBypass to True. (PrintReceiptSentFontToB to 0 in Resto) [] POS Config[]setting.xml[]Printer Settings[]DisableBypass=True[]PrintReceiptSentFontToB=0[]
4. On POS Config, in POS settings, set Print Chinese Characters to True.

Installation Manuals

[POS Config, POS Settings Print Chinese Characters=True]

Unique solution ID: #1134
Author: Mary Nicole Quirabu
Last update: 2019-10-21 13:16